

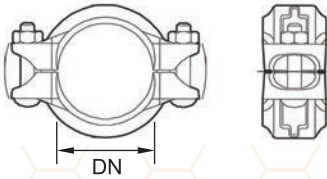

GROOVED COUPLINGS & FLANGE ADAPTORS



Style 1GS Rigid Coupling

CNG style 1GS is a light weight rigid coupling for rigid sprinkler system. Style 1GS is especially designed to provide a rigid, locked-in connection to meet the specified demands of rigid design steel pipe.

Size		Max. Work Pressure		Size		Max. Work Pressure	
DN / Inches	mm	Bar / PSI		DN / Inches	mm	Bar / PSI	
32 / 1 1/4"	42.4	52 / 750		125 / 5"	133.0	35 / 500	
40 / 1/2"	48.3	52 / 750		125 / 5"	139.7	35 / 500	
50 / 2"	60.3	42 / 600		150 / 6"	165.1	35 / 500	
65 / 2 1/2"	73.0	38 / 550		150 / 6"	168.3	35 / 500	
65 / 2 1/2"	76.1	38 / 550		200 / 8"	219.1	25 / 350	
80 / 3"	88.9	38 / 550		250 / 10"	273.0	25 / 350	
100 / 4"	114.3	35 / 500		300 / 12"	323.9	25 / 350	

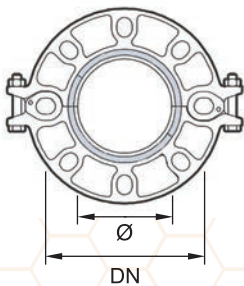
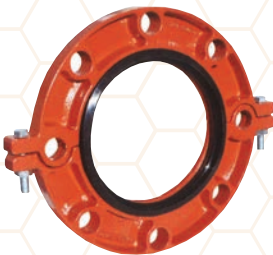

Style "321" Split Flange Plate

CNG Style 321 Split Flange Plate is designed with oral flange holes to suit both ANSI Class 125 / 150 and **PN16 flange connection**.

Size		Max. Work Pressure		Dimension		Size		Max. Work Pressure		Dimension	
DN / Inches	mm	Bar / PSI		Z mm	Ø mm	DN / Inches	mm	Bar / PSI		Z mm	Ø mm
65 / 2 1/2"	73.0	35 / 500		22	145	125 / 5"	139.7	35 / 500		22	210
65 / 2 1/2"	76.1	35 / 500		22	145	125 / 5"	141.3	35 / 500		26	210
80 / 3"	88.9	35 / 500		22	160	150 / 6"	165.1	35 / 500		24	240
100 / 4"	114.3	35 / 500		24	180	150 / 6"	168.3	35 / 500		26	240
						200 / 8"	219.1	28 / 400		30	295

Ø = Pitch Circle Diameter (PCD)

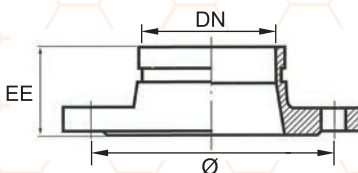

Style "321G" Flange Adaptor Nipple

CNG Style 321G Flange Adaptor Nipple is designed with oral flange holes to suit both ANSI Class 125/150 and **PN16 flange connection**. Recommended for heavy load pipeline or pump outlet connection

Size		EE		Size		EE	
DN / Inches	mm	mm / Inches	Ø mm	DN / Inches	mm	mm / Inches	Ø mm
50 / 2"	60.3	70 / 2.75	125	125 / 5"	141.3	80 / 3.15	210
65 / 2 1/2"	73.0	70 / 2.75	145	150 / 6"	165.1	100 / 3.95	240
65 / 1/2"	76.1	70 / 2.75	145	150 / 6"	168.3	100 / 3.95	240
80 / 3"	88.9	70 / 2.75	160	200 / 8"	219.1	100 / 3.95	295
100 / 4"	114.3	80 / 3.15	180	250 / 8"	273.0	150 / 5.9	355
125 / 5"	139.7	80 / 3.15	210	300 / 12"	323.9	150 / 5.9	410

Ø = Pitch Circle Diameter (PCD)